

TREE SUMMARY

15 TREES WERE SURVEYED IN THIS AREA. THE TREES ARE ALL CLOSE TOGETHER IN THE LOCATION SHOWN ON THE SKETCH. EIGHT TREES ARE PENETRATIONS TO THE PART 77 APPROACH SURFACE. FOUR ARE 3-6' PENETRATIONS AND 4' ARE 1-3' PENETRATIONS. THE OTHER SEVEN TREES ARE 0-5' BELOW THE PART 77 APPROACH SURFACE. THE SIZE AND SPECIES OF THE TREES IS AS FOLLOWS: TWO 10" OAK, EIGHT 8" OAK, AND FIVE 6" OAK.

TREES SHOWN ON THESE DRAWINGS ARE BASED ON TREES THAT WERE ABLE TO BE SURVEYED IN THE FIELD IN APRIL 2013. SOME ADDITIONAL TREES MAY EXIST THAT ARE OBSCURED BY OTHER TREES. SOME ADDITIONAL TREE GROWTH IS EXPECTED RESULTING IN ADDITIONAL FUTURE OBSTRUCTIONS.

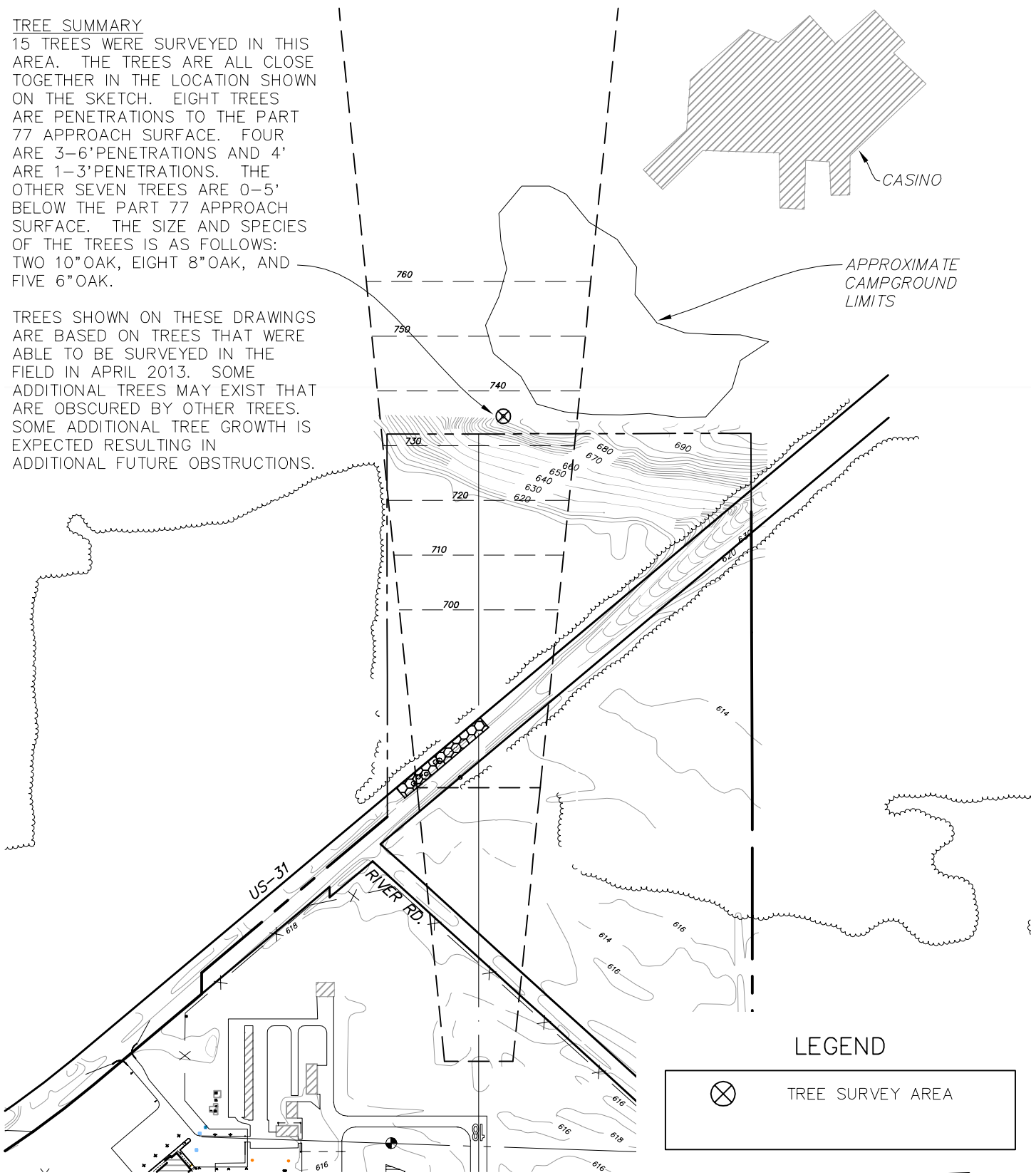

LEGEND

⊗	TREE SURVEY AREA
---	------------------

SITE PLAN North
 SCALE : 1" = 500'

	MANISTEE BLACKER AIRPORT MANISTEE, MICHIGAN	PROJECT No. 2120043
	PROPOSED TREE CLEARING AND REMOVAL	DATE JUNE 2013
		SHEET No. 1 OF 2

APPROXIMATE
CAMPGROUND
LIMITS

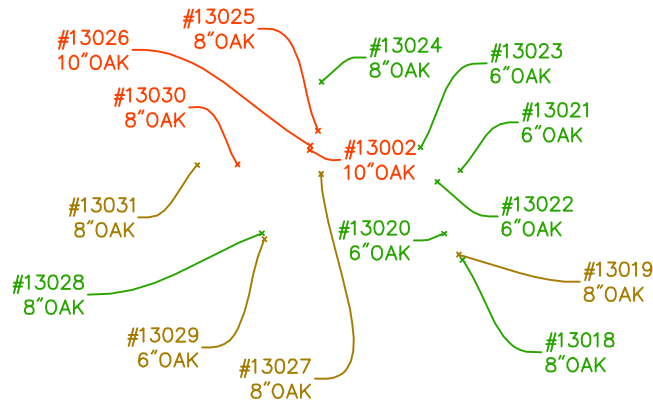

DETAIL TREE PLAN

SCALE : 1" = 30'

North



TREE HEIGHTS

<u>3-6' PENETRATION</u>	<u>0-3' PENETRATION</u>	<u>0-5' BELOW</u>
13002	13031	13018
13026	13027	13020
13030	13019	13021
13025	13029	13022
		13023
		13024
		13028

NOTE

TREES SHOWN ON THESE DRAWINGS ARE BASED ON TREES THAT WERE ABLE TO BE SURVEYED IN THE FIELD IN APRIL 2013. SOME ADDITIONAL TREES MAY EXIST THAT ARE OBSCURED BY OTHER TREES. SOME ADDITIONAL TREE GROWTH IS EXPECTED RESULTING IN ADDITIONAL FUTURE OBSTRUCTIONS.